

QUICK SPECS

Weight	18,136 lbs
Horsepower	56.9 HP
Max Dig Depth	15'4"



YANMAR's ViO80-1A, our 8-ton class mini excavator, is powered by a 56.9 HP

Tier 4 Final YANMAR engine. It is our largest true zero tail swing excavator, goes where large conventional tail swing models can't and comes with emissions control combined with fuel efficiency. The ViO80-1A comes standard with 2nd PTO and is packed with several convenient functions and features to provide operator comfort, ease of operation and easy maintenance. Plus, YANMAR's unique SmartAssist Remote gives you peace of mind with theft prevention and maintenance management tools as well as other remote monitoring services.

INNOVATIVE FEATURES



True Zero Tail Swing

YANMAR introduced the world's first zero tail swing excavator in 1993. True zero tail swing technology means no part of the housing extends beyond the tracks, allowing you to work efficiently anywhere, with less damage to the machine and the worksite.



YANMAR's Patented Hydraulic Quick Coupler

The standard hydraulic quick coupler makes changing buckets fast and easy. With the exception of fitting and removing the safety lock pin, the entire operation is performed electronically while you're seated in the comfort of the cab. Less hassle. Less downtime. More productivity.



A Cab Almost As Comfortable As Your Living Room

The spacious ViO80-1A cab is designed for more elbow and leg room. The standard equipment heating and air conditioning system means you can work comfortably year round. And the sturdy, sound-blocking, anti-vibration construction means a smooth, quiet ride. All it needs is a TV.



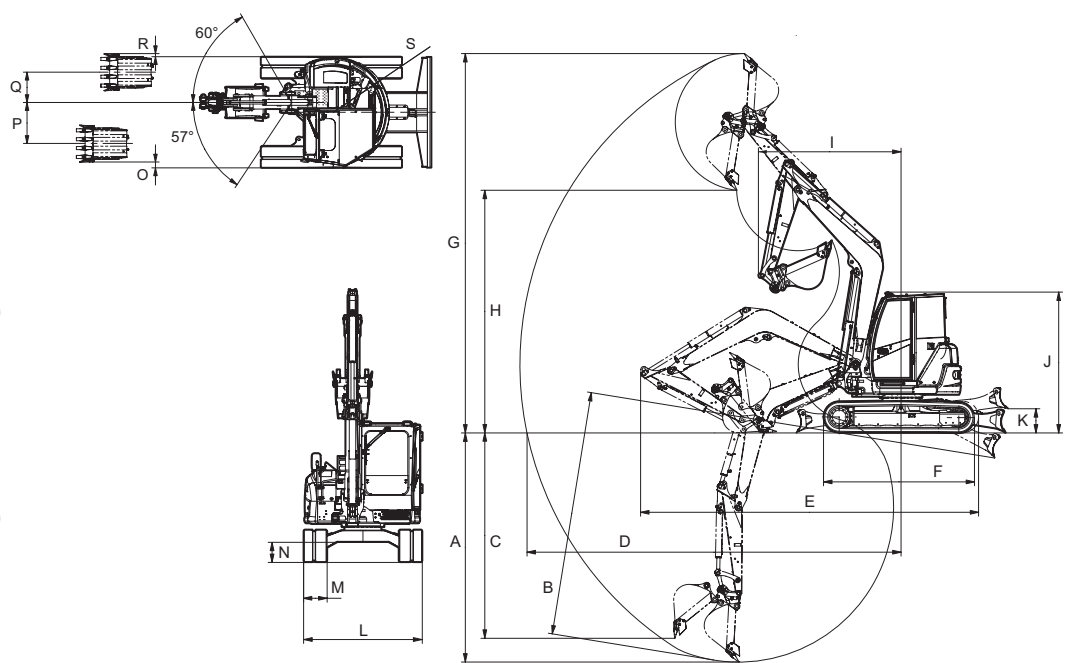

- A** 14'5" (4,400)
- B** 15'4" (4,680)
- C** 12'11" (3,940)
- D** 23'5" (7,140)
- E** 21'2" (6,460)
- F** 9'6" (2,890)
- G** 23'9" (7,230)
- H** 15'2" (4,620)
- I** 8'11" (2,720)
- J** 8'10" (2,680)
- K** 1'6" (460)
- L** 7'5" (2,270)
- M** 1'6" (450)
- N** 1'3" (390)
- O** 5" (120)
- P** 2'9" (840)
- Q** 2'0" (620)
- R** 2" (60)
- S** 3'9" (1,135)

Specifications

Model		ViO80-1A	
Type		Cab. Rubber Track	Cab. Steel Track
Operating Weight		lbs (t)	18,136 (8.23) / 18,268 (8.29)
Engine	Type	Water-cooled 4-cylinder diesel	
	Model	YANMAR 4TNV98C-WBV	
	Rated Output	HP (kW)/rpm	56.9 (42.4) / 2,000
	Maximum Output at High Idle Speed	HP (kW)/rpm	55.7 (41.5) / 1,900
Performance	Max Digging Force, Bucket / Arm	lbs (kN)	14,275 (63.5)* / 9,172 (40.8)*
	Traveling Speed, High / Low	MPH (km / h)	2.8 (4.5) / 1.6 (2.5) / 2.6 (4.1) / 1.4 (2.3)
	Swing Speed	RPM	9.0
	Boom Swing Angle, (L / R)	degrees	57° / 60°
	Gradability	degrees	30°
Ground Contact Pressure (Rubber Track)		PSI (kPa)	5.2 (35.8) / 5.25 (36.2)
Hydraulic System	Pump Capacity	GPM (L / min)	18.6 (70.3) x 2 + 14.1 (53.2) + 5.0 (19.0)
	Main Relief Set Pressure	PSI (MPa)	3,698 (25.5) x 2 + 3,481 (24.0) + 421 (2.9)
Blade Dimensions	Width	ft-in (mm)	7'5" (2,260)
	Stroke, Raise / Lower from G.L.	ft-in (mm)	1'6" (460) / 1'7" (480) / 1'5" (440) / 1'8" (500)
Fuel tank capacity		Gals (L)	30.4 (115)

*without quick coupler

- Hydraulic Quick Coupler*
- Blade
- Boom Swing Function
- Rubber Tracks
- Arm End Auxiliary Valve
- Antenna and Pre-wired for Radio
- Back Mirror/Side Mirror
- 2-way Pattern Control
- ROPS / FOPS Cabin
- Windshield Washer
- Air Conditioner
- Defroster
- Joystick Pilot Controls
- Arm Rests (Adjustable)
- Suspension and Reclining Seat
- Seat Belt
- PTO Switch
- Travel Automatic Dual Speed Switch
- Auto Deceleration Switch
- Eco Mode Switch
- Engine Stop Switch
- Traveling Alarm
- Floor Mats
- PTO2 Circuit

Hydraulic PTO

Combined Flow, Double Actions	3,481 (24,000)	31.7 (120.0)	18.6 (70.3)
-------------------------------	----------------	--------------	-------------

*Also available without Quick Coupler.

Lifting Capacity

LIFT POINT HEIGHT in (mm)	(R) LIFT RADIUS in (mm)											
	RATED LIFT CAPACITY OVER END BLADE DOWN lbs (kg)				RATED LIFT CAPACITY OVER END BLADE UP lbs (kg)				RATED LIFT CAPACITY OVER SIDE BLADE UP lbs (kg)			
	MAX	196.9 (5,000)	157.1 (4,000)	118.1 (3,000)	MAX	196.9 (5,000)	157.1 (4,000)	118.1 (3,000)	MAX	196.9 (5,000)	157.1 (4,000)	118.1 (3,000)
196.9 (5,000)	3,638 (1,650)		3,572 (1,620)		3,550 (1,610)		3,461 (1,570)		2,734 (1,240)		3,550 (1,610)	
157.5 (4,000)	3,417 (1,550)	3,417 (1,550)	3,572 (1,620)		2,403 (1,090)	2,734 (1,240)	3,417 (1,550)		2,271 (1,030)	2,491 (1,130)	3,528 (1,600)	
118.1 (3,000)	3,483 (1,580)	3,616 (1,640)	4,233 (1,920)	5,468 (2,480)	2,028 (920)	2,668 (1,210)	4,123 (1,870)	5,336 (2,420)	1,896 (860)	2,447 (1,110)	4,145 (1,880)	5,534 (2,510)
78.7 (2,000)	3,351 (1,520)	3,946 (1,790)	5,027 (2,280)	6,879 (3,120)	1,830 (830)	2,513 (1,140)	3,594 (1,630)	6,174 (2,800)	1,697 (770)	2,315 (1,050)	3,395 (1,540)	4,806 (2,180)
39.4 (1,000)	3,395 (1,540)	4,255 (1,930)	5,710 (2,590)	7,651 (3,470)	1,764 (800)	2,381 (1,080)	3,439 (1,560)	4,564 (2,070)	1,675 (760)	2,249 (1,020)	3,175 (1,440)	4,255 (1,930)
Ground (0)	3,373 (1,530)	4,321 (1,960)	5,865 (2,660)	8,070 (3,660)	1,830 (830)	2,337 (1,060)	3,307 (1,500)	4,873 (2,210)	1,719 (780)	2,160 (980)	3,153 (1,430)	4,542 (2,060)
-39.4 (-1,000)	3,329 (1,510)	4,057 (1,840)	5,468 (2,480)	7,585 (3,440)	2,028 (920)	2,315 (1,050)	3,285 (1,490)	5,137 (2,330)	1,918 (870)	2,160 (980)	3,087 (1,400)	4,674 (2,120)
-78.7 (-2,000)	2,976 (1,350)		4,498 (2,040)	6,218 (2,820)	2,491 (1,130)		3,373 (1,530)	5,292 (2,400)	2,425 (1,100)		3,197 (1,450)	4,961 (2,250)

Please note that the standard equipment may vary from this list. Consult your YANMAR dealer for confirmation.

For parts, please visit YANMAR.com/us/products/parts/ or call 800.966.7685.